

xkone

**3 YEARS
WARRANTY**



EN

Recessed spot lights, fixed, round or square, for LED bulbs, PAR16, GU10 type or for XCOMBO LED modules, CM12.
Frame of die-cast aluminum, electrostatically painted.
GU10 socket of ceramics.

Range of applications

Lighting for shops or exhibition areas.
General interior lighting.

Lamps and LED modules are not included.

RO

Spoturi încastrate în plafon fals, fixe, rotunde sau pătrate, pentru becuri cu LED tip PAR16, GU10 sau pentru module cu LED-uri XCOMBO, CM12.
Rama din aluminiu turnat sub presiune, vopsită în câmp electrostatic.
Dulie GU10 din ceramică.

Aplicații

Iluminatul spațiilor comerciale sau al zonelor de expunere.
Iluminatul general de interior.

Becurile și modulele LED nu sunt incluse.

IT

Faretti ad incasso fissi, rotondi o quadrati, per lampadine a LED tipo PAR16, GU10, o per moduli a LED modello XCOMBO, CM12.
Cornice in pressofusione di alluminio verniciata a polveri.
Attacco GU10 in ceramica.

Campi di applicazione

Illuminazione per negozi o aree espositive.
Illuminazione generale di interni.

Lampadine e moduli LED non sono inclusi.



KN01

FINISHING AVAILABLE

MWH MBK

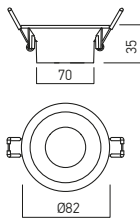

KN02

FINISHING AVAILABLE

MWH MBK

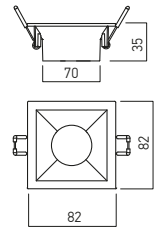

Code	Finishing	Bulbs type	Socket	Power	Input voltage		Weight
KN01 MWH	MWH	PAR16	GU10	1x50W max.	230V AC	Ø70 mm	0,07 kg
KN01 BK	MBK	PAR16	GU10	1x50W max.	230V AC	Ø70 mm	0,07 kg

Code	Finishing	Bulbs type	Socket	Power	Input voltage		Weight
KN02 MWH	MWH	PAR16	GU10	1x50W max.	230V AC	70x70 mm	0,09 kg
KN02 BK	MBK	PAR16	GU10	1x50W max.	230V AC	70x70 mm	0,09 kg

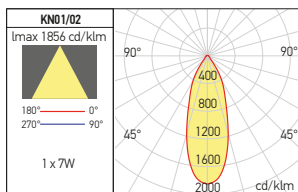

RECOMMENDED BULBS AND LED MODULES

