

IP20 LED STRIP USER MANUAL



Protection level: IP20

 **Not waterproof**



Please read the manual carefully before the installation and usage, and use the product in the correct way. Instructions of accessories are included in the manual. Please properly maintain the manual after reading and understanding it for convenient reference by all users of the product in the future.

Processing instructions

- 1** Cut the appropriate length on the outside of the side of the minimum cutting point

- ⚠ Cutting LED strip at the minimum cutting unit.



- 3** Uncover the 3M glue release paper on the back of the light strip in proper order and stick it to the installation position.

- ⚠ The mounting surface should be cleaned in advance.
- ⚠ It is strictly forbidden to tear off the 3M glue release paper on the back of the light strip at one time.
- ⚠ It is strictly forbidden to press lights or and work when power is on.



- 2** Solder the red and black wires on the light strip with an electric soldering iron or fix them on the strip with solder-free terminals

- ⚠ Pay attention to the positive and negative poles.

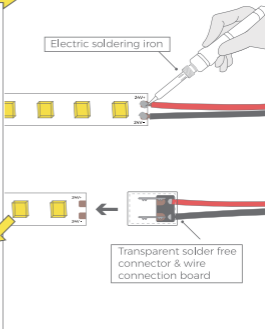

Turn on the power

- 1** Install the power supply in a suitable location

⚠️⚠️ Do not touch with wet hands to prevent electric shock.



- 2** Connect the red and black wires of the light strip to the power supply



- 3** Turn on the power and light up the light strip

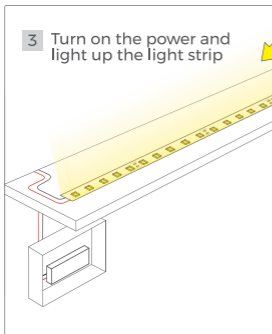

Connect to DIM.

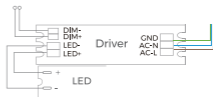

Notice

Installation Precautions



Install in the space without chemicals like sulfur, acid, halogen.



The ambient temperature of the product is -20 ~ 40°C.



The quality of atmosphere should not be lower than the national secondary standard.



IP20 light strip(not waterproof)product is for indoor use only, and the air humidity should not exceed 55%.



To ensure the luminous effect, every five meters long strip should be connected to a driver.



During the installation process, pay attention to the positive and negative poles of the power cord, and do not connect them wrongly. The power output must be consistent with the product voltage.



Light strip products will release a lot of heat during use, and the product must be used in a ventilated environment.



Please pay attention to the operation, when the power is working, do not touch the AC power terminal to prevent electric shock.



To avoid the damaged components caused by surge voltage or unstable current, please use the stable driver to power up the strip.



It is recommended to use only 80% electricity of the driver to protect the strip from damage caused by overload.



To ensure the long life span of strip, please do not pull the strip or driver wire hard during installation and using.



In order to ensure the life and reliability of the light strip, please do not bend it in an arc less than 60mm in diameter, and do not fold it in half to avoid damage to the lamp beads or break.

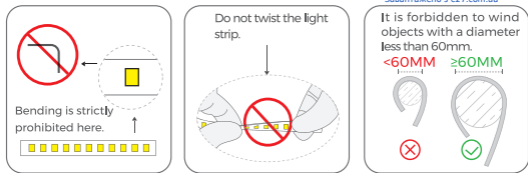

For non-user replaceable light sources:

"The light source contained in this luminaire shall only be replaced by the manufacturer or his service agent or a similar qualified person".

Product Warranty

- A warranty period of three years is provided for products in normal use. For any faults arising during the period that are approved to be quality issue after inspected by our company, a product of the same model will be replaced for free.
- The warranty does not cover any of the following situations:
 - (1) Any product damage due to usage not allowed in the instructions.
 - (2) Any product damage due to disassembling or wrong operations by the user.
 - (3) Severe appearance damage or deformation of the product.

FAQ

Q: Why are all leds not lit or no color changing?

A: Please check the following item:

- (1) If the power is on.
- (2) If the polarity is connected reversely.
- (3) If there is a short circuit in exterior power supply.
- (4) If there is a short circuit caused by automatic short-circuit protection for driver.
- (5) If the fuse is burned; if there is, please replace the fuse.

Please take the appropriate measures to solve the problem if there is any problem listed above.

Q:Why are some strip not lit?

A:Please check the following item:

- (1)If every power supply is on.
- (2)If there is an error in circuit.

If there is, please check the driver circuit to eliminate the faults.

Q:Why is there inconsistent brightness in LED or the LED is not bright enough?

A:Please check the following item:

- (1)If there is overload in power supply; if yes, please add more drivers.
- (2)If there is too much loss in switching power supply circuit, if there is, please thicken the driver wire or make the driver closer to the strip. Make sure the voltage of per five meter strip is kept above 95% of the rated voltage.
- (3)If there are too many strips connected in series, if yes, please adjust the numbers of strip to the numbers that can be driven by the power supply.

Q:Why does the LED flashes?

A:Please check if the connection is in poor contact, if yes, please find out the bad unit.

Q:Why are there individual leds not lit?

A:Please check if it is caused by static breakdown, or by the faradic electricity breakdown of equipment, or by electricity leakage, if yes, please make sure the related electrical appliances are connected to the earth wire correctly and replace the LEDS.

This user manual is subject to change without notice. COLORS does not assume any legal responsibility for the damage caused by this user manual. Without the authorization of COLORS, do not copy all or part of this user manual.



Official website



You tube



Tel: +86-755-2923 1888

E-mail: colors@colorsled.com

Web: www.colorsled.com

Add: Building A5, Qixing Wisdom Park, Shiyao