

# INSTALLATION MANUAL

10112DH

**ecolight**



**DARK LIGHT**



**90 CRI**



700mA | COB LED | 12W | IP20 | Die cast  
Requires 700mA driver / Complete with honeycomb.



82mm



40mm



72mm

60mm



40cm

**one**  
LIGHT

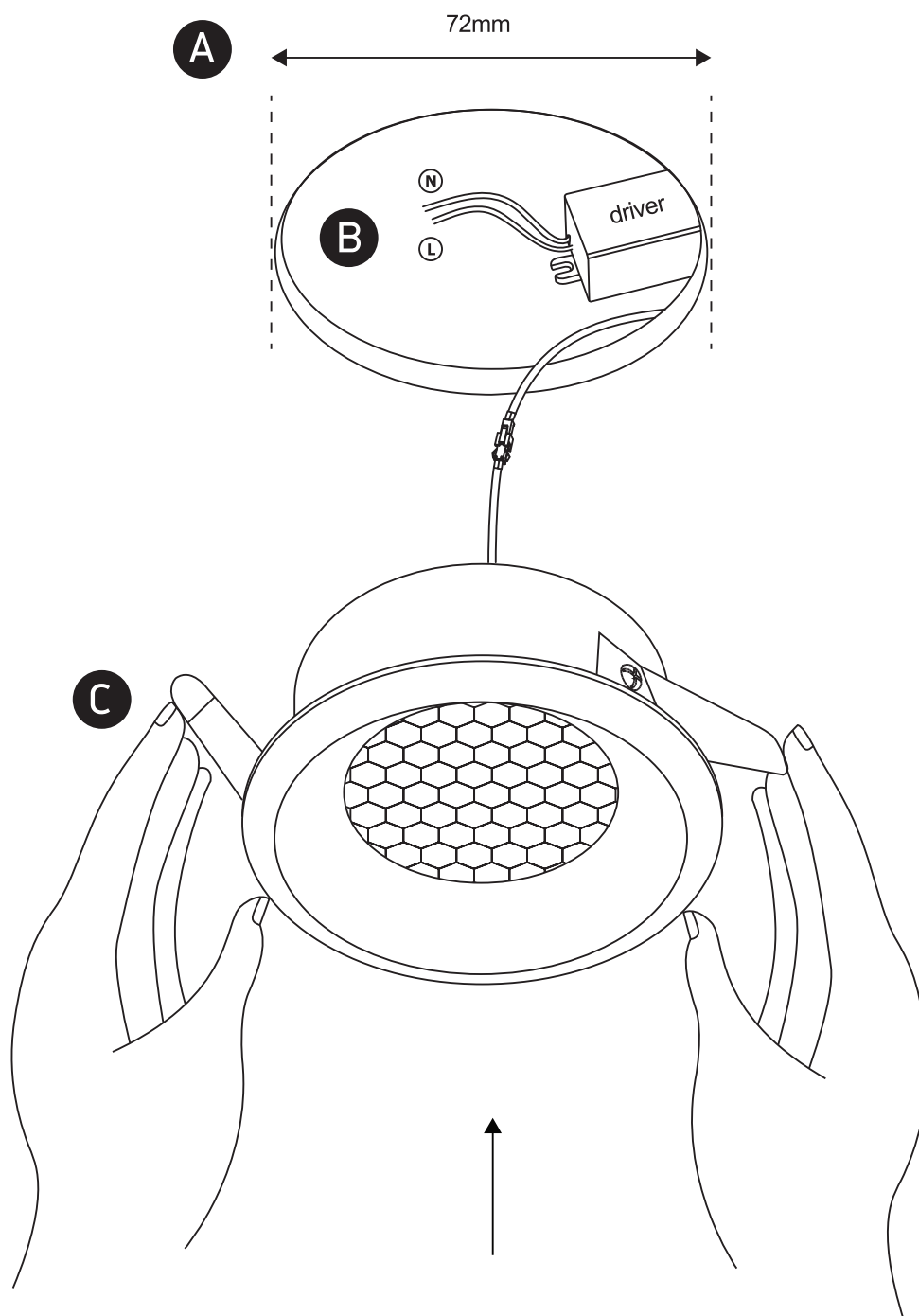

## Warnings:

1. Make sure that the product is installed properly before connecting to electricity.
2. Do not cover the fitting.
3. Maintenance and installation should only be carried out by a professional electrician.