

# INSTALLATION MANUAL

## 11107D

**ecolight**



DARK LIGHT



ADJUSTABLE

QUICK FIX

90 CRI



700mA | 7W | IP54 | Die cast | Adjustable

Requires 700mA driver.

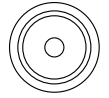

100mm



62mm



92mm

90mm

40cm

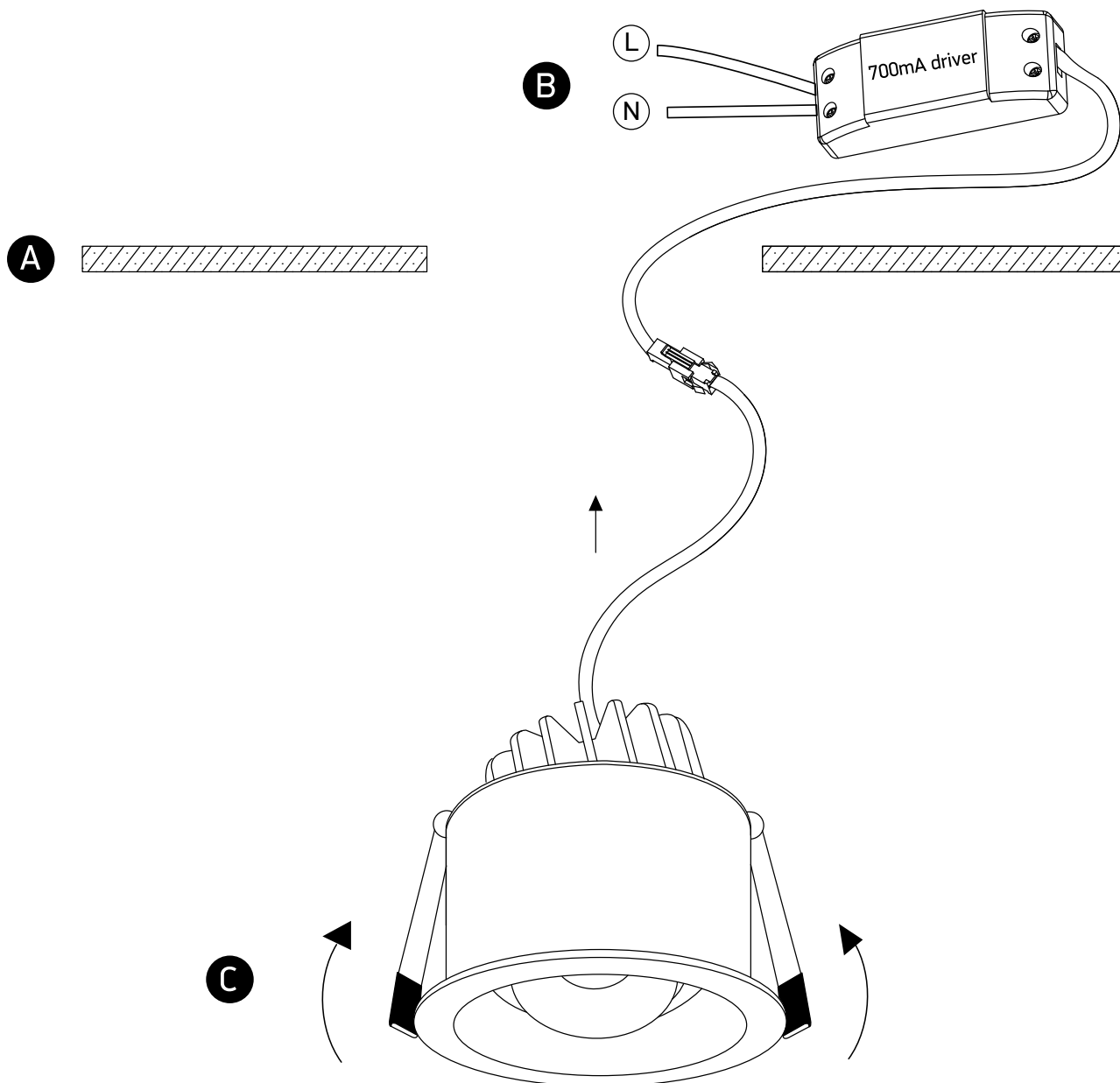
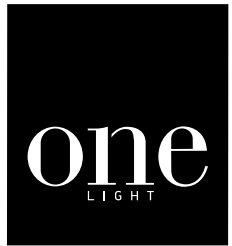

### Warnings:

1. Make sure that the product is installed properly before connecting to electricity.
2. Do not cover the fitting.
3. Maintenance and installation should only be carried out by a professional electrician.