

INSTALLATION MANUAL

62018F, 62030F, 62038F, 62046F

ecolight



**80
CRI**



230V | SMD 4014 | 18W / 30W / 38W / 46W | IP40 | Aluminium + PC

Complete with driver.

one
LIGHT

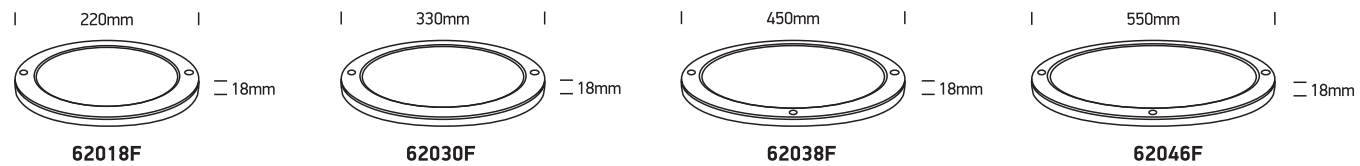

SURFACE MOUNTED

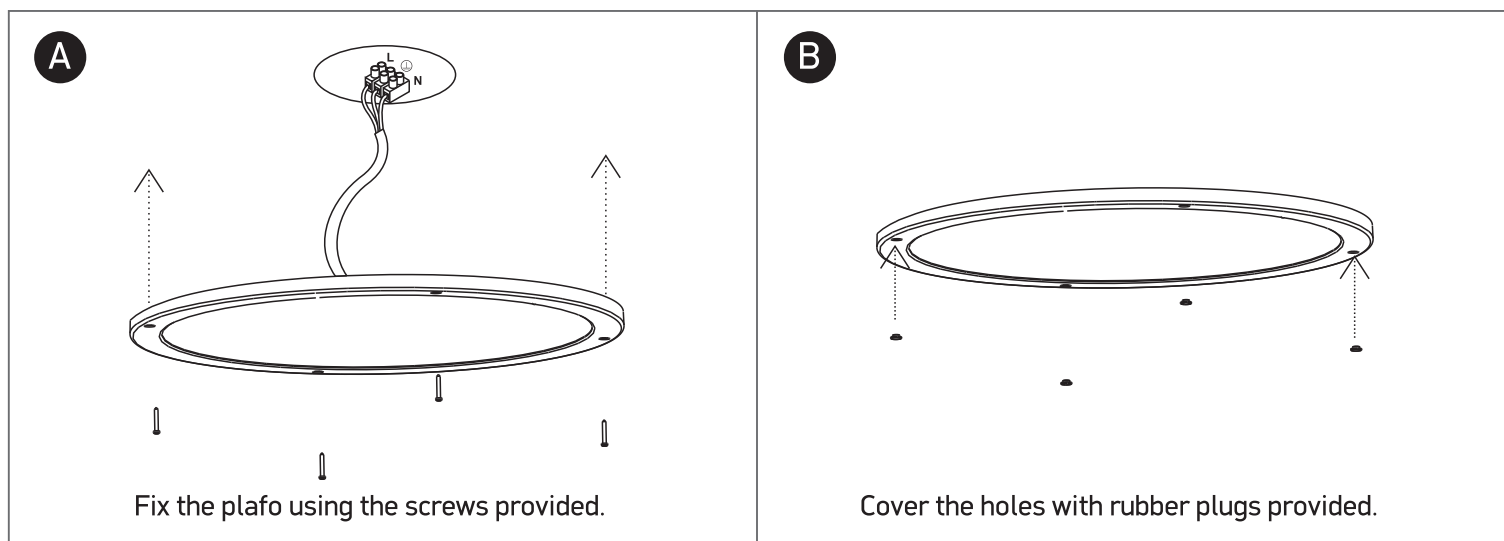

INSTALL IN PRE-INSTALLED ORDINARY CEILING BACKBOX (USE THE BRACKET)

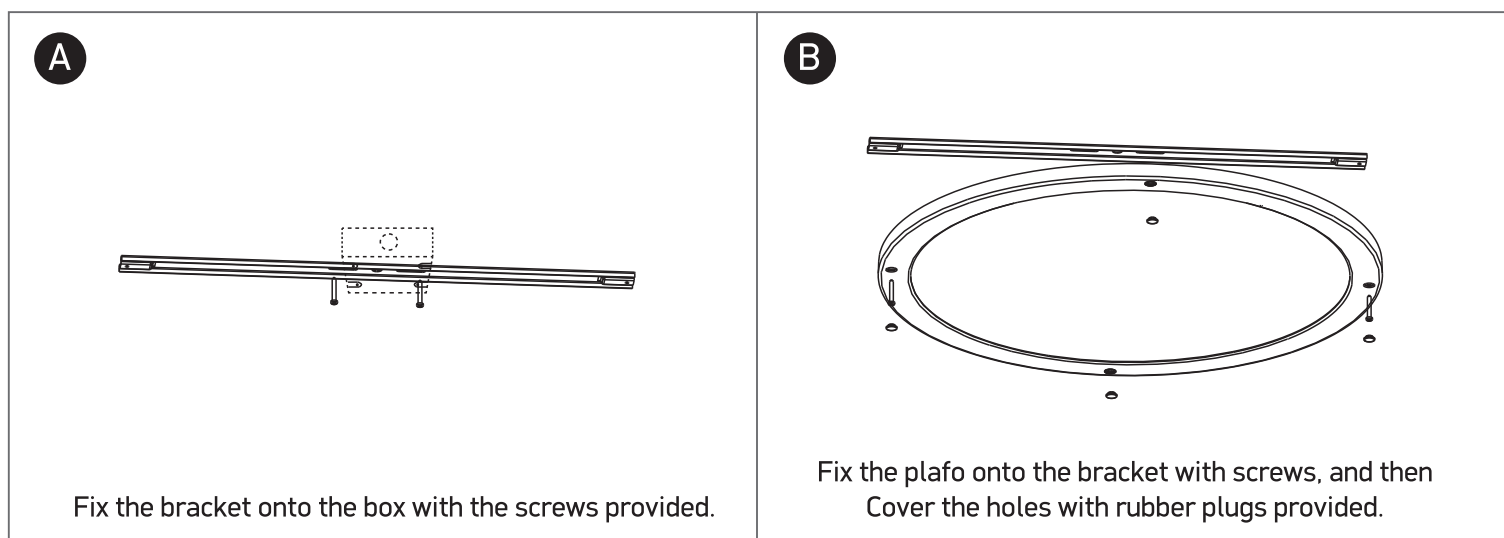

Warnings:

1. Make sure that the product is installed properly before connecting to electricity.
2. Do not cover the fitting.
3. Maintenance and installation should only be carried out by a professional electrician.