

# INSTALLATION MANUAL

65738A

**ecolight**

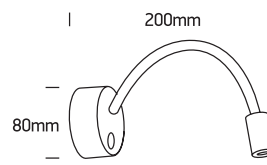

230V | LED | 3W | IP20 | Aluminium  
Complete with 700mA driver.

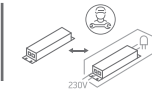

85 CRI

**one**  
LIGHT

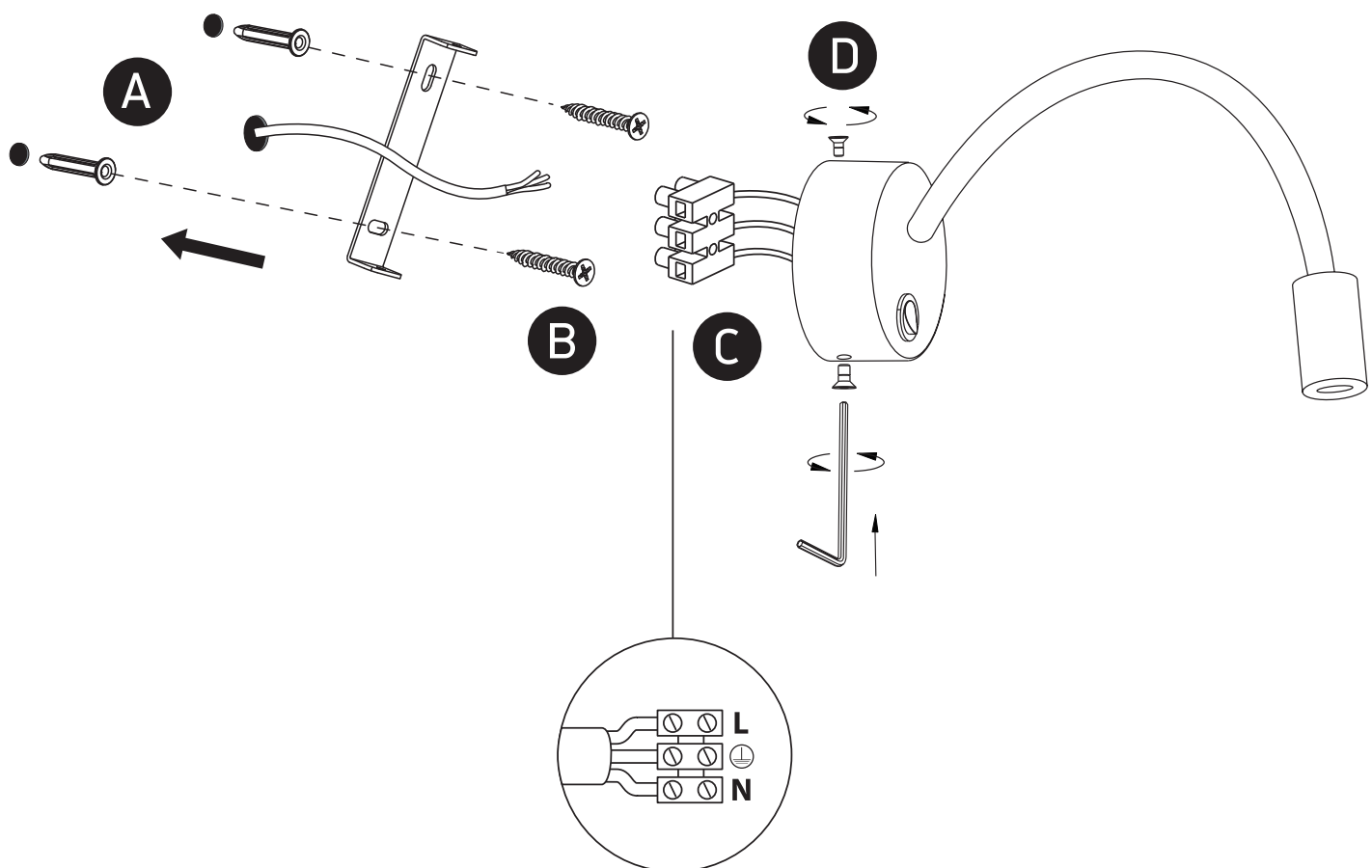

## Warnings:

1. Make sure that the product is installed properly before connecting to electricity.
2. Do not cover the fitting.
3. Maintenance and installation should only be carried out by a professional electrician.