

# INSTALLATION MANUAL

7010A



100-240V | PAR38 | E27 | 80W | IP65 | Stainless steel 316 | Adjustable

Supplied with base & spike.

200cm

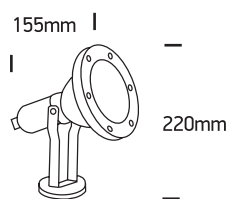

one  
LIGHT

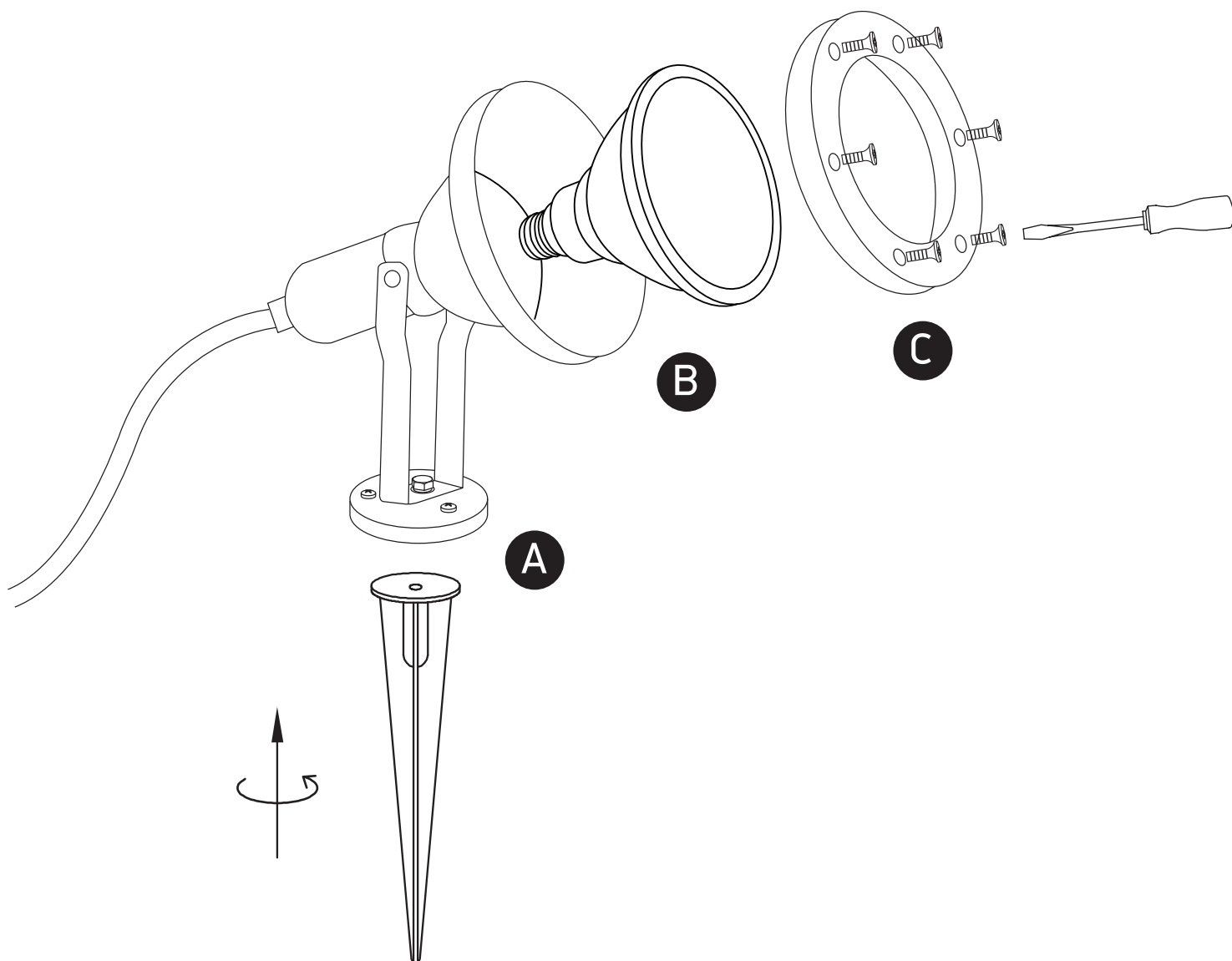

## Warnings:

1. Make sure that the product is installed properly before connecting to electricity.
2. Do not cover the fitting.
3. Maintenance and installation should only be carried out by a professional electrician.