

INSTALLATION MANUAL

7068

ecolight

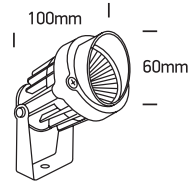

230V | 6W | IP65 | Die cast | Adjustable

Complete with driver.
Supplied with spike.

80 CRI

200cm

one
LIGHT

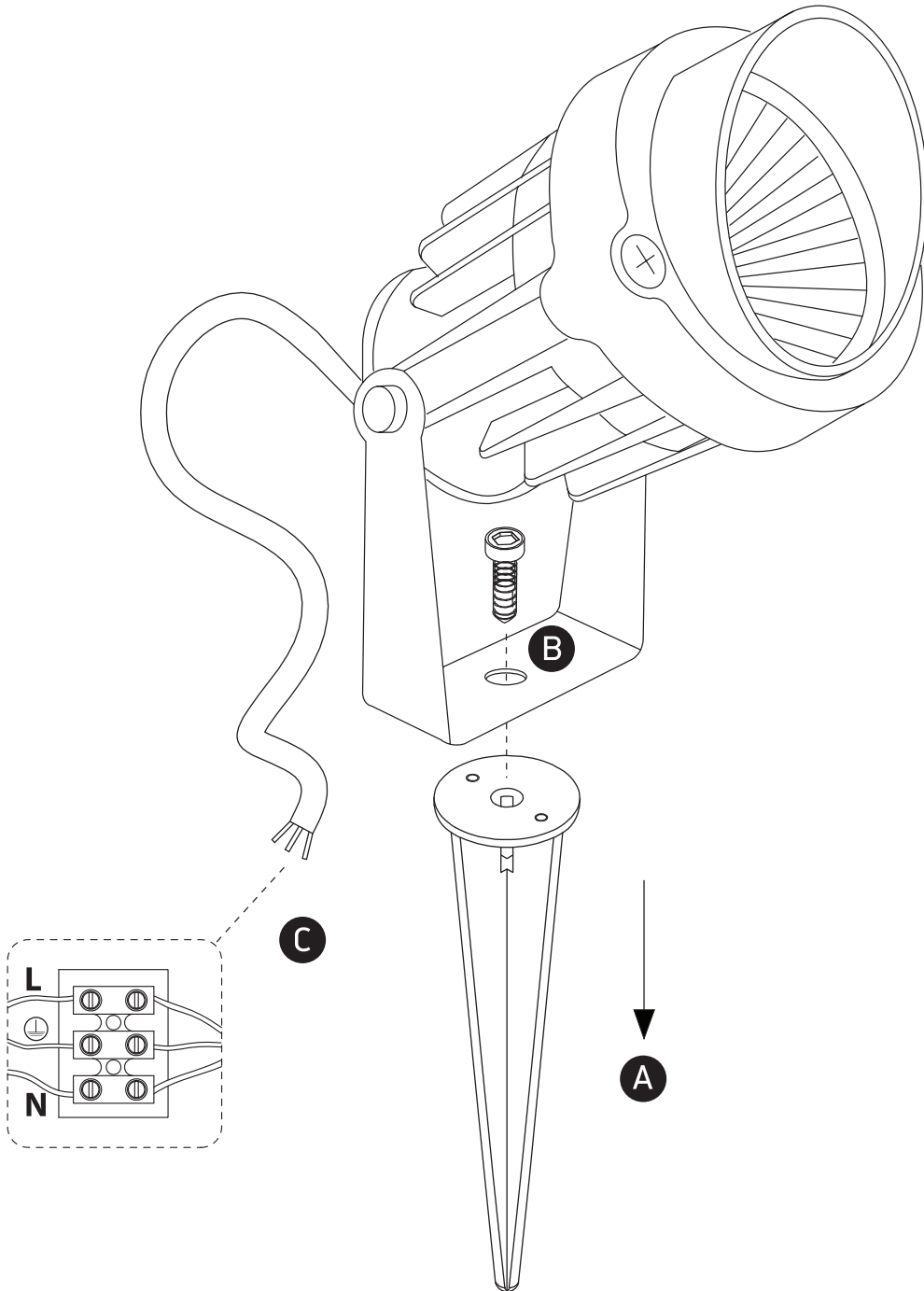

Warnings:

1. Make sure that the product is installed properly before connecting to electricity.
2. Do not cover the fitting.
3. Maintenance and installation should only be carried out by a professional electrician.